

PERFORMANCE, DURABILITY, AFFORDABILITY...

PLUS SUPERIOR HIGH LOAD BEARING CAPABILITY

INTRODUCING the New BIO-CHANNEL SB, the latest innovation by Robbins...

The All NEW BIO-CHANNEL SB System Benefits Include:

- Safe guards the well-being of the athlete
- Passes ALL global performance standards worldwide, including the stringent MFMA 3rd party certification, **PUR**, which is strongly governed by the MFMA
- Continuous interwoven subfloor design is perfect for carrying heavy loads
- System "bottoms" out on itself during heavy rolling or static loads
- Elongated anchor slots allow lateral movement to reduce build up of stress, maintaining structural integrity
- Anchored for dimensional stability and uniformity for long -term superior game play
- Computer-assisted manufacturing technology for quality assurance

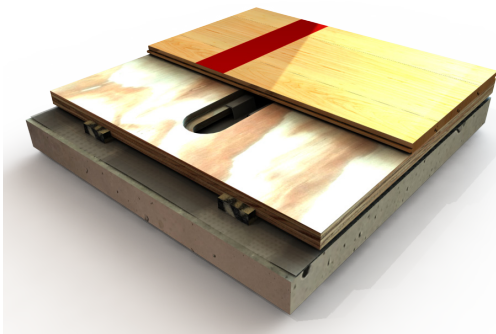

robbinsfloor.com | 1.800.543.1913

Robbins, Inc. | 4777 Eastern Avenue | Cincinnati, OH 45226

MAPLE FLOORING SYSTEMS

Product Specifications

System Type	Anchored Resilient Panel
Slab Depression	1 3/4" (44mm) with 25/32" (20mm) maple
Surface- MFMA Northern Hard Maple	Robbins Continuous Strip® XL (FJ)
Exceeds Industry Testing Standards:	MFMA PUR DIN 18032 part 2 2001 DIN 18032 part 2 1991 ASTM F2772-09 FIBA Level 1 EN 14904 Type 4
Anchorage	Heavy Duty Anchor Spike with Metal Channel
Subfloor Construction	Nominal 3/4" x 48" x 96" subfloor sheathing that has factory prepared anchor slots & resilient padding slots
Resilience Layer	9/16" Zero/G® Shock Pad Strip
Vapor Barrier	6 MIL Polyethylene
Optional Construction	Contact a Robbins Representative for Alternative Systems
LEED Contributions	MR credit 4, 5, & 7 IEQ 4.1, 4.2, 4.3, 4.4 FSC® Lumber Available <i>*Credits are based on products selected and location of facility</i>



Wall View

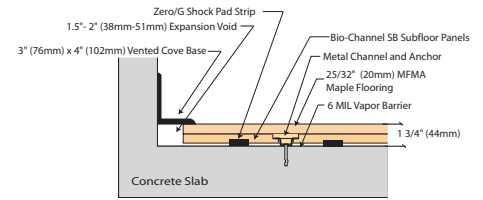

Threshold View

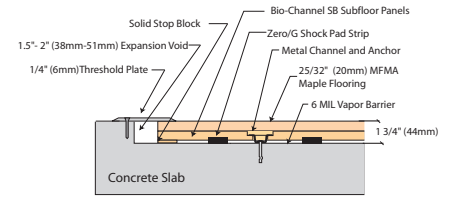

Equipment View

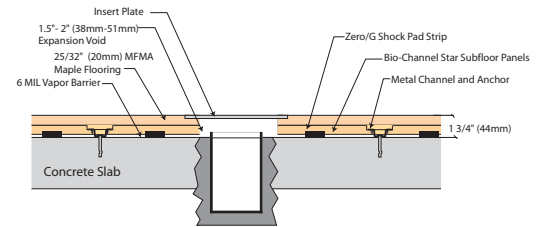

Bio-Channel SB Reference Facilities

LakePoint Sporting Community
Emerson, GA 120,000 sq. ft.

Valdosta State University
Valdosta, GA 19,000 sq. ft.

Jacksonville State University
Jacksonville, AL 9,800 sq. ft.

Letchworth CSD
Gainesville, NY 7,300 sq. ft.

