

Bio-Channel Star (BCH)

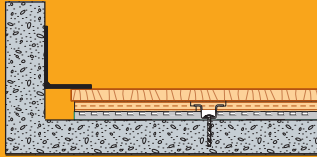

FEATURES:

- 25/32" or 33/32" MFMA Finger-Jointed Maple
- Patented Factory Prepared Subfloor Panel
- Continuous Variable Stage Resilient Blanket (made from 100% recycled materials)
- Larger and More Frequent Heavy Duty Channel Anchors
- Anchor Spikes

ATTRIBUTES/BENEFITS:

- Technologically-enhanced, stronger, longer, & straighter than random length maple
- Designed to accept heavy duty channel for correct depth anchorage for uniformity & assures quality
- Provides total uniform support, resilience, & vibration damping
- Channel is 8 times larger compared to industry standard to provide superior stability & uniformity over time
- Secures system channel and resists loosening over time from vibrations

BCH EQ₁

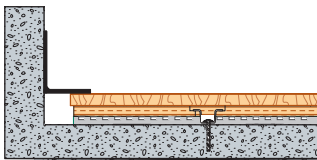

FEATURES:

- 25/32" or 33/32" MFMA Random Length Maple
- Patented Factory Prepared Subfloor Panel
- Continuous Variable Stage Resilient Blanket (made from 100% recycled compound)
- Heavy Duty Channel Anchors
- Anchor Spikes

ATTRIBUTES/BENEFITS:

- Provides an aesthetically pleasing wear surface
- Designed to accept heavy duty channel for correct depth anchorage for uniformity & quality control
- Provides total uniform support & resilience
- Provides stability & uniformity over time
- Secures system channel and resists loosening over time from vibrations

BCH EQ₂

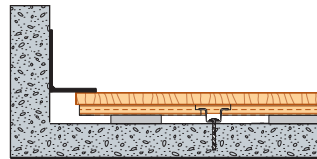

FEATURES:

- 25/32" or 33/32" MFMA Random Length Maple
- Patented Factory Prepared Subfloor Panel
- Variable Stage Spaced Lineal Padding (made from 100% recycled compound)
- Heavy Duty Channel Anchors
- Anchor Spikes

ATTRIBUTES/BENEFITS:

- Provides an aesthetically pleasing wear surface
- Designed to accept heavy duty channel for correct depth anchorage for uniformity & quality control
- Provides under system airflow & resilience
- Provides stability & uniformity over time
- Secures system channel and resists loosening over time from vibrations

BCH EQ₃

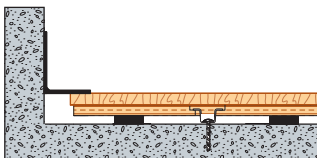

FEATURES:

- 25/32" or 33/32" MFMA Random Length Maple
- Patented Factory Prepared Subfloor Panel
- Variable Stage Spaced Individual Pads (made from recycled compound)
- Heavy Duty Channel Anchors
- Anchor Spikes

ATTRIBUTES/BENEFITS:

- Provides an aesthetically pleasing wear surface
- Designed to accept heavy duty channel for correct depth anchorage for uniformity & quality control
- Provides under system airflow & resilience
- Provides stability & uniformity over time
- Secures system channel and resists loosening over time from vibrations